

MIN. 16GA. (1.5mm) GALVANIZED STEEL STUDS OR FURRING AT 16" (400mm) O.C. MAX AND AT EACH PANEL JOINT

FACTORY INSTALLED 14GA. (2mm) GALVANIZED EDGE PLATES

STRUCTURAL SILICONE ATTACH BETWEEN ANCHOR PLATES

StoneLite[®] PANEL "CUT-AWAY" TO SHOW CLARITY OF PANEL ATTACHMENT. ATTACH TO STUD FRAME BETWEEN JOINTS W/ STRUCTURAL SILICONE.

NO. 10 (5mm) TEK SCREW ATTACH THRU SLOTTED HOLE ATTACHING PANEL TO STEEL STUDS

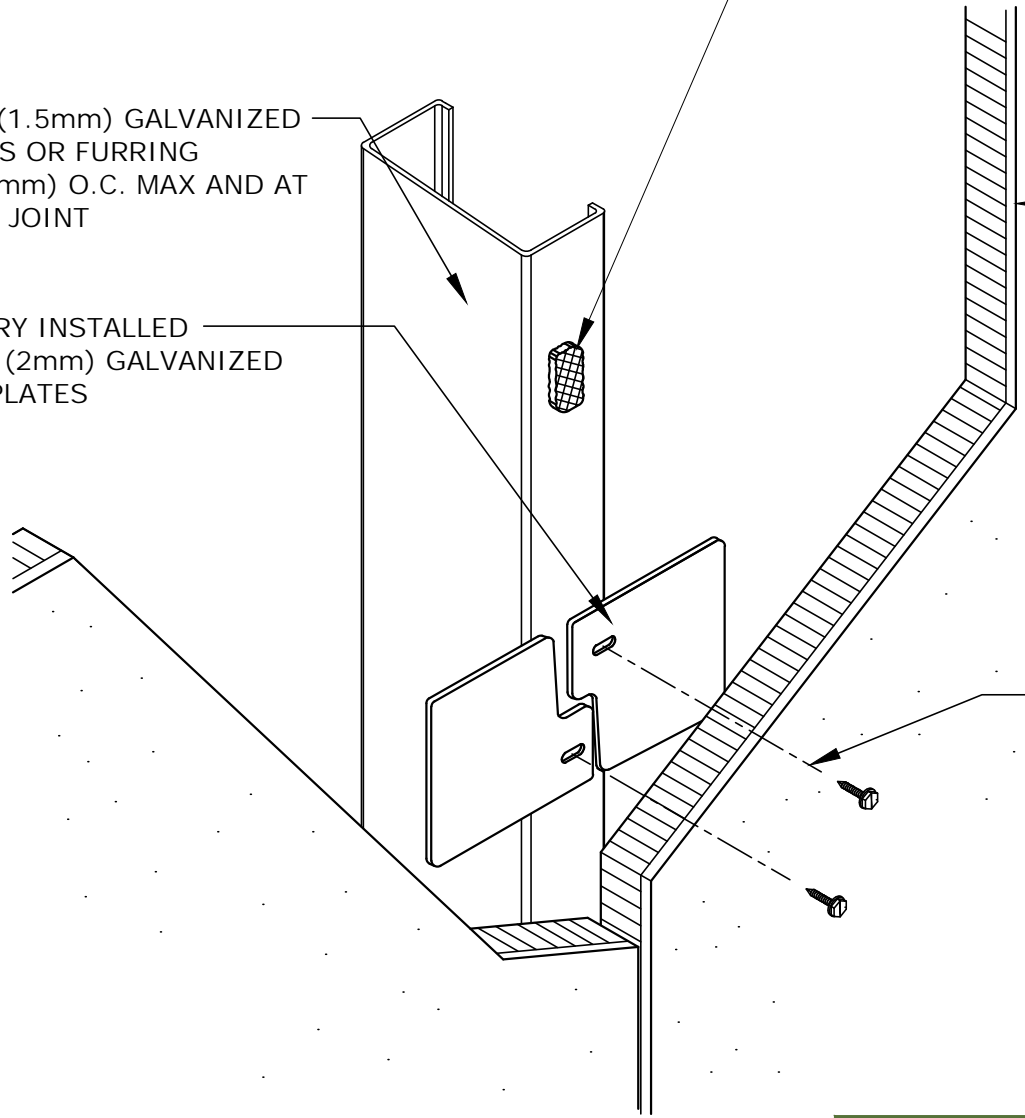

SP-13

EDGE PLATE ATTACHMENT

Stonepanels
INTERNATIONAL LLC

2400 HWY 1431 WEST
Marble Falls, TX 78654
800.328.6275
www.stonepanels.com